

## Series 415

# Butt Fusion Tapping Saddle

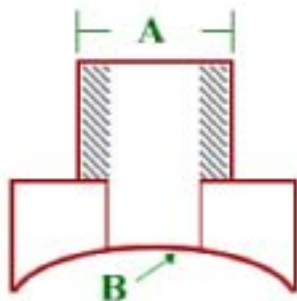

Branch Outlet Sizes NPT <b>A</b>	Base Pipe Sizes IPS and DIPS <b>B</b>
1/2"	2">
3/4"	2">
1"	2">
1 1/4"	2">
1 1/2"	2">
2"	3">
3"	4">
4"	6">

### The POLY-CAM Butt Fusion Tapping Saddle

#### Product Specifications:

Manufactured for installation on PE 3408 Polyethylene Pipe

ASTM D 2513

ASTM 3035

ASTM F 714

AWWA C 901

AWWA C 906

Tapping Saddle fittings are available in pressure class 100 and 150

## Series 415

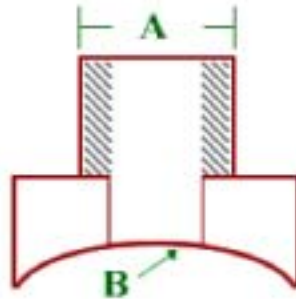

## Butt Fusion Tapping Saddle



### The POLY-CAM Butt Fusion Tapping Saddle

#### Materials:

Polyethylene Branch Saddle: ASTM D 3350

PE 3408 (Black) Cell classification 345454C

Threaded Brass insert: Brass Alloy C 360 or 303, 316 Stainless Steel

All materials meet requirements of NSF-Standard #61

#### Test Standards:

Tapping Saddles are manufactured and assembled at POLY-CAM facilities and can be tested to the following standards:

- ATSM D 1598: Sustained Pressure Test
- ATSM D 1599: Burst Pressure Test
- ATSM D 1588: Constant-Tensile Load Joint Test (CTLJT)
- AWWA C 906: Class 160

All POLY-CAM Tapping Saddles are manufactured with precision machined threads to ensure optimal fit between saddle and valve.

Threaded inserts are manufactured with hex flange for rotation prevention during installation.

Standard fusion machines required for installation.

Fusion procedures and specification available on request.

Fusion face tooling available from POLY-CAM.